

СКВАЖИННЫЕ НАСОСЫ СЕРИИ NR 201 X-A-B-C



2900 1/мин

Гидравлические характеристики

Тип	Двигатель		Потребляемый ток А 3- 400 В	Q	U.S.ф.р.л.																									
	кВт	НР			0	53	70	97	110	123	141	158	176	198	0	12	16	22	25	28	32	36	40	45						
NR-201 X/2"	4	5,5	9,4	H (m)	49,5	45,5	44	42	38	35	29	24																		
NR-201 X/3"	5,5	7,5	12,3		75	69	66	63	58	52	45	36																		
NR-201 X/4"	7,5	10	16,3		100	92	88	84	78	70	60	48																		
NR-201 X/5"	9	12,5	19,3		125	115	110	105	98	87	75	60																		
NR-201 X/6"	11	15	23,8		150	138	132	125	117	104	90	72																		
NR-201 X/7"	13	17,5	27,8		175	161	154	146	137	122	105	84																		
NR-201 X/8"	15	20	30,4		200	184	176	167	156	139	120	96																		
NR-201 X/10"	18,5	25	38		250	230	220	209	195	174	150	120																		
NR-201 X/12"	22	30	43,7		300	276	264	250	234	208	180	144																		
NR-201 X/14"	26	35	52,3		350	322	308	292	273	243	210	168																		
NR-201 X/16"	30	40	60,2		400	368	352	334	312	278	240	192																		
NR-201 X/18"	37	50	70,5		450	414	396	376	351	313	270	216																		
NR-201 X/20"	37	50	70,5		500	460	440	418	390	348	300	240																		
NR-201 X/22"	45	60	89		550	506	484	460	429	383	330	264																		
NR-201 X/24"	45	60	89		600	552	528	500	468	416	360	288																		
NR-201 X/26"	51	70	101		650	598	572	543	507	452	390	312																		
NR-201 X/28"	59	80	118		700	644	616	584	546	486	420	336																		
NR-201 X/30"	59	80	118		750	690	660	627	585	522	450	360																		
NR-201 X/32"	66	90	131		800	736	704	668	624	556	480	384																		
NR-201 X/34"	66	90	131		850	782	748	710	663	591	510	408																		
Минимальный гидростатический уровень в м.						1	1	1	1	1	1	1																		
NR-201A/2"	5,5	7,5	12,3		H (m)	53		48	45	43	41	37	33	28	21															
NR-201A/3"	7,5	10	16,3			79		72	68	64	62	56	49	42	31															
NR-201A/4"	9	12,5	19,3			105		97	90	86	82	74	65	55	41															
NR-201A/5"	13	17,5	27,7	132			120	113	107	103	93	81	69	51																
NR-201A/6"	15	20	30,4	158			145	136	129	124	111	98	83	62																
NR-201A/7"	18,5	25	38	184			169	158	150	144	130	114	97	72																
NR-201A/8"	22	30	43,7	211			193	181	171	165	148	130	111	82																
NR-201A/9"	22	30	43,7	237			217	203	193	185	167	146	125	92																
NR-201A/10"	26	35	52,3	263			241	226	214	206	185	162	138	103																
NR-201A/11"	26	35	52,3	290			265	248	236	226	204	179	152	113																
NR-201A/12"	30	40	60,2	316			289	271	257	247	222	195	166	123																
NR-201A/14"	37	50	70,5	366			334	315	303	288	264	231	197	144																
NR-201A/16"	45	60	89	421			385	361	343	329	296	260	221	164																
NR-201A/18"	45	60	89	474			433	406	386	370	333	293	249	185																
NR-201A/20"	51	70	101	527			482	452	428	412	370	325	277	205																
NR-201A/22"	59	80	118	571			524	493	472	447	407	353	295	223																
NR-201A/24"	59	80	118	632			578	542	514	494	444	390	329	236																
NR-201A/26"	66	90	131	686			629	595	572	541	498	438	367	267																
Минимальный гидростатический уровень в м.								1	1	1	1	1	1	1	1															
Тип	Двигатель		Потребляемый ток А 3- 400 В	Q		U.S.ф.р.л.																								
	кВт	НР				0	158	176	198	220	247	277	308	352	396	422	476	502	528	0	36	40	45	50	56	63	70	80	90	96
NR-201B/2"	9	12,5	19,3	H (m)		51	46	45	44	42	40	37	33	28	21															
NR-201B/3"	15	20	30,4			77	69	68	66	63	60	56	50	42	31															
NR-201B/4"	18,5	25	38			102	92	90	88	84	80	74	66	56	41															
NR-201B/5"	26	35	52,3		128	115	113	110	105	100	93	83	70	52																
NR-201B/6"	30	40	60,2		153	138	135	132	126	120	111	99	82	59																
NR-201B/7"	37	50	70,5		179	161	158	154	147	140	130	116	98	65																
NR-201B/8"	37	50	70,5		204	184	180	176	168	160	148	132	112	74																
NR-201B/9"	45	60	89		245	216	213	204	199	189	174	153	124	89																
NR-201B/10"	51	70	101		272	240	237	233	224	213	194	174	140	102																
NR-201B/12"	59	80	118		326	288	284	279	269	255	232	211	163	122																
NR-201B/14"	66	90	131		380	336	338	326	314	299	274	241	194	144																
NR-201B/16"	75	100	147		436	390	386	380	369	350	319	282	232	169																
NR-201B/18"	92	125	177		481	439	434	427	415	387	355	312	254	188																
NR-201B/19"	92	125	177		518	463	458	451	435	411	377	338	274	207																
NR-201B/20"	92	125	177		546	488	482	474	461	438	406																			
Минимальный гидростатический уровень в м.						1	1	1	1	1	1	2	2	2																
NR-201C/2A"	11	15	23,8		H (m)	50			39	37	35	33	30	24	21	15	10													
NR-201C/2"	13	17,5	27,7			58			48	47	45	42	38	33	30	22	20	15												
NR-201C/3A"	15	20	30,4			75			59	56	53	50	45	36	32	23														
NR-201C/3"	18,5	25	38			87			72	71	67	63	57	50	45	33	29	23												
NR-201C/4"	22	30	43,7			116			96	94	89	84	76	66	60	44	39	30												
NR-201C/5"	30	40	60,2			145				120	118	111	105	95	83	75	55	49	38											
NR-201C/6"	37	50	70,5			174				144	141	133	126	114	99	90	66	58	45											
NR-201C/7"	45	60	89			203				168	165	156	147	133	116	105	82	68	53											
NR-201C/8"	45																													

СКВАЖИННЫЕ НАСОСЫ СЕРИИ NR 201B

Гидравлические характеристики

Тип	Двигатель		Потребляемый ток А 3~	U _{с.дв.} В	Q																	
	кВт	HP			0	53	70	97	110	123	141	158										
NR-201 X/2"	4	5.5	9.4	0	0	12	16	22	25	28	32	36	0	200	267	367	417	467	533	600		
NR-201 X/3"	5.5	7.5	12.3	0	49.5	45.5	44	42	38	35	29	24	H (m)	75	69	66	63	58	52	45	36	
NR-201 X/4"	7.5	10	16.3	0	100	92	88	84	78	70	60	48		125	115	110	105	98	87	75	60	48
NR-201 X/5"	9	12.5	19.3	0	150	138	132	125	117	104	90	72		175	161	154	146	137	122	105	84	66
NR-201 X/6"	11	15	23.8	0	200	184	176	167	156	139	120	96		200	184	176	167	156	139	120	96	75
NR-201 X/7"	13	17.5	27.7	0	250	230	220	209	195	174	150	120		250	230	220	209	195	174	150	120	96
NR-201 X/8"	15	20	30.4	0	300	276	264	250	234	208	180	144		350	322	308	292	273	243	210	168	132
NR-201 X/10"	18.5	25	38	0	400	368	352	334	312	278	240	192		400	368	352	334	312	278	240	192	144
NR-201 X/12"	22	30	43.7	0	450	414	396	376	351	313	270	216		450	414	396	376	351	313	270	216	168
NR-201 X/14"	26	35	52.9	0	500	460	440	418	390	348	300	240		550	506	484	460	429	383	330	264	200
NR-201 X/16"	30	40	60.2	0	600	552	528	500	468	416	360	288		600	552	528	500	468	416	360	288	220
NR-201 X/18"	37	50	70.5	0	650	598	572	543	507	452	390	312		650	598	572	543	507	452	390	312	240
NR-201 X/20"	37	50	70.5	0	700	644	616	584	546	486	420	336		700	644	616	584	546	486	420	336	264
NR-201 X/22"	45	60	89	0	750	690	660	627	585	522	450	360		750	690	660	627	585	522	450	360	288
NR-201 X/24"	45	60	89	0	800	736	704	668	624	556	480	384		800	736	704	668	624	556	480	384	312
NR-201 X/26"	51	70	101	0	850	782	748	710	663	591	510	408		850	782	748	710	663	591	510	408	336
NR-201 X/28"	59	80	118	0																		
NR-201 X/30"	59	80	118	0																		
NR-201 X/32"	66	90	131	0																		
NR-201 X/34"	66	90	131	0																		

Минимальный гидростатический уровень в м.

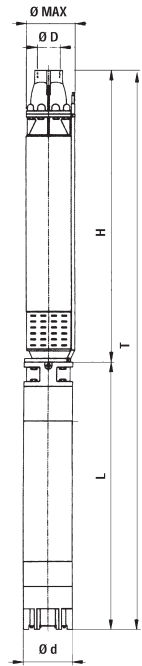

Размеры и вес

Тип		T (mm)	H (mm)	L (mm)	Ø Max (mm)	Ø D °G	Ø d (mm)	L + H		Kg	
T	H							L	NEMA	H	T
NR-201 X/2	RP-201 X/2	1165	644	521	190	3"	144	6" MS 152	NEMA 1.18.413	45,5	85,5
NR-201 X/3	RP-201 X/3	1260	708	552	190	3"	144	6" MS 152	NEMA 1.18.413	51	95
NR-201 X/4	RP-201 X/4	1367	772	595	190	3"	144	6" MS 152	NEMA 1.18.413	56	105
NR-201 X/5	RP-201 X/5	1471	836	635	190	3"	144	6" MS 152	NEMA 1.18.413	61	115
NR-201 X/6	RP-201 X/6	1585	900	685	190	3"	144	6" MS 152	NEMA 1.18.413	66	126
NR-201 X/7	RP-201 X/7	1689	964	725	190	3"	144	6" MS 152	NEMA 1.18.413	71,5	133,5
NR-201 X/8	RP-201 X/8	1803	1028	775	190	3"	144	6" MS 152	NEMA 1.18.413	76,5	182
NR-201 X/10	RP-201 X/10	2131	1256	875	190	3"	144	6" MS 152	NEMA 1.18.413	87	206
NR-201 X/12	RP-201 X/12	2349	1384	965	190	3"	144	6" MS 152	NEMA 1.18.413	97	229
NR-201 X/14	RP-201 X/14	2567	1512	1055	190	3"	144	6" MS 152	NEMA 1.18.413	108	277
NR-201 X/16	RP-201 X/16	2803	1668	1135	190	3"	144	6" MS 152	NEMA 1.18.413	118	309
NR-201 X/18	RP-201 X/18	3211	1896	1315	190	3"	144	6" MS 152	NEMA 1.18.413	128	319
NR-201 X/20	RP-201 X/20	3339	2024	1315	190	3"	144	6" MS 152	NEMA 1.18.413	139	351
NR-201 X/22	RP-201 X/22	3160	2152	1008	198	3"	192	8" MS 200	NEMA 1.18.424	149	383
NR-201 X/24	RP-201 X/24	3288	2280	1008	198	3"	192	8" MS 200	NEMA 1.18.424	159	393
NR-201 X/26	RP-201 X/26	3486	2408	1078	198	3"	192	8" MS 200	NEMA 1.18.424	170	425
NR-201 X/28	RP-201 X/28	3428	2280	1148	198	3"	192	8" MS 200	NEMA 1.18.424	180	457
NR-201 X/30	RP-201 X/30	3912	2764	1148	198	3"	192	8" MS 200	NEMA 1.18.424	190	467
NR-201 X/32	RP-201 X/32	4140	2892	1248	198	3"	192	8" MS 200	NEMA 1.18.424	200	499
NR-201 X/34	RP-201 X/34	4268	3020	1248	198	3"	192	8" MS 200	NEMA 1.18.424	210	509

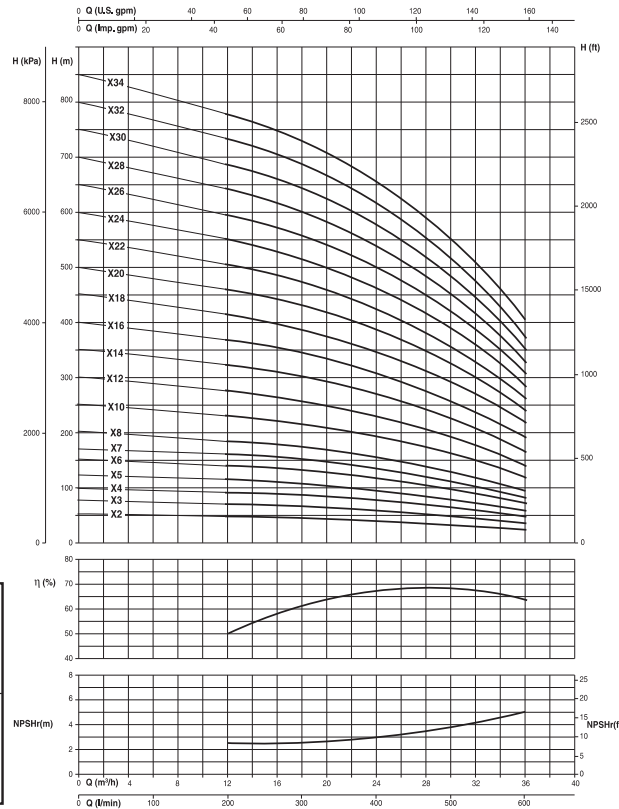

Количество ступеней	<5	5-6	7-8	>8
	Коэффициент			
	0,97	0,98	0,99	1

СКВАЖИННЫЕ НАСОСЫ СЕРИИ NR 201A



2900 1/мин

Гидравлические характеристики

Тип	Двигатель		Потребляемый ток А 3~	U.S.g.p.m. Q л/мин	0	71	97	110	123	141	158	176	198
	kW	HP			400V	0	16	22	25	28	32	36	40
NR-201A/2*	5,5	7,5	12,3	H (m)	53	48	45	43	41	37	33	28	21
NR-201A/3*	7,5	10	16,3		79	72	68	64	62	56	49	42	31
NR-201A/4*	9	12,5	19,3		105	97	90	86	82	74	65	55	41
NR-201A/5*	13	17,5	27,7		132	120	113	107	103	93	81	69	51
NR-201A/6*	15	20	30,4		158	145	136	129	124	111	98	83	62
NR-201A/7*	18,5	25	38		184	169	158	150	144	130	114	97	72
NR-201A/8*	22	30	43,7		211	193	181	171	165	148	130	111	82
NR-201A/9*	22	30	43,7		237	217	203	193	185	167	146	125	92
NR-201A/10*	26	35	52,3		263	241	226	214	206	185	162	138	103
NR-201A/11*	26	35	52,3		290	265	248	236	226	204	179	152	113
NR-201A/12*	30	40	60,2		316	289	271	257	247	222	195	166	123
NR-201A/14*	37	50	70,5		366	334	315	303	288	264	231	197	144
NR-201A/16	45	60	89		421	385	361	343	329	296	260	221	164
NR-201A/18	45	60	89		474	433	406	386	370	333	293	249	185
NR-201A/20	51	70	101		527	482	452	428	412	370	325	277	205
NR-201A/22	59	80	118		571	524	493	472	447	407	353	295	223
NR-201A/24	59	80	118		632	578	542	514	494	444	390	329	236
NR-201A/26	66	90	131		686	629	595	572	541	498	438	367	267

Минимальный гидростатический уровень в м.

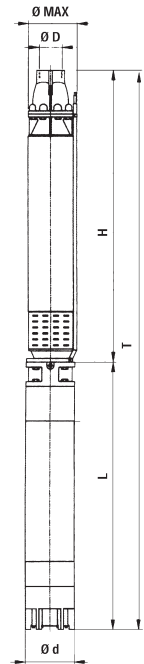

Размеры и вес

Тип	T	H	T (mm)	H (mm)	L (mm)	Ø Max (mm)	Ø D °G	Ø d (mm)	L + H			Kg	
									L	NEMA	H	T	
NR-201A/2	RP-201A/2		1196	644	552	190	3"	144	6" MS 152	NEMA 1.18.413	40,5	84,5	
NR-201A/3	RP-201A/3		1303	708	595	190	3"	144	6" MS 152	NEMA 1.18.413	45,1	94,1	
NR-201A/4	RP-201A/4		1407	772	635	190	3"	144	6" MS 152	NEMA 1.18.413	49,7	103,7	
NR-201A/5	RP-201A/5		1561	836	725	190	3"	144	6" MS 152	NEMA 1.18.413	54,3	116,3	
NR-201A/6	RP-201A/6		1675	900	775	190	3"	144	6" MS 152	NEMA 1.18.413	58,9	123,9	
NR-201A/7	RP-201A/7		1839	964	875	190	3"	144	6" MS 152	NEMA 1.18.413	63,5	144,5	
NR-201A/8	RP-201A/8		1993	1028	965	190	3"	144	6" MS 152	NEMA 1.18.413	68,1	159,1	
NR-201A/9	RP-201A/9		2157	1192	965	190	3"	144	6" MS 152	NEMA 1.18.413	72,7	163,7	
NR-201A/10	RP-201A/10		2311	1256	1055	190	3"	144	6" MS 152	NEMA 1.18.413	77,3	180,3	
NR-201A/11	RP-201A/11		2375	1320	1055	190	3"	144	6" MS 152	NEMA 1.18.413	81,9	184,9	
NR-201A/12	RP-201A/12		2519	1384	1135	190	3"	144	6" MS 152	NEMA 1.18.413	86,5	195,5	
NR-201A/14	RP-201A/14		2827	1512	1315	190	3"	144	6" MS 152	NEMA 1.18.413	95,7	225,7	
NR-201A/16	RP-201A/16		2676	1668	1008	198	3"	192	8" MS 200	NEMA 1.18.424	105	264	
NR-201A/18	RP-201A/18		2904	1896	1008	198	3"	192	8" MS 200	NEMA 1.18.424	114,2	273,2	
NR-201A/20	RP-201A/20		3102	2024	1078	198	3"	192	8" MS 200	NEMA 1.18.424	123,4	295,4	
NR-201A/22	RP-201A/22		3300	2152	1148	198	3"	192	8" MS 200	NEMA 1.18.424	132,6	320,6	
NR-201A/24	RP-201A/24		3428	2280	1148	198	3"	192	8" MS 200	NEMA 1.18.424	141,8	329,8	
NR-201A/26	RP-201A/26		3656	2408	1248	198	3"	192	8" MS 200	NEMA 1.18.424	151	354	

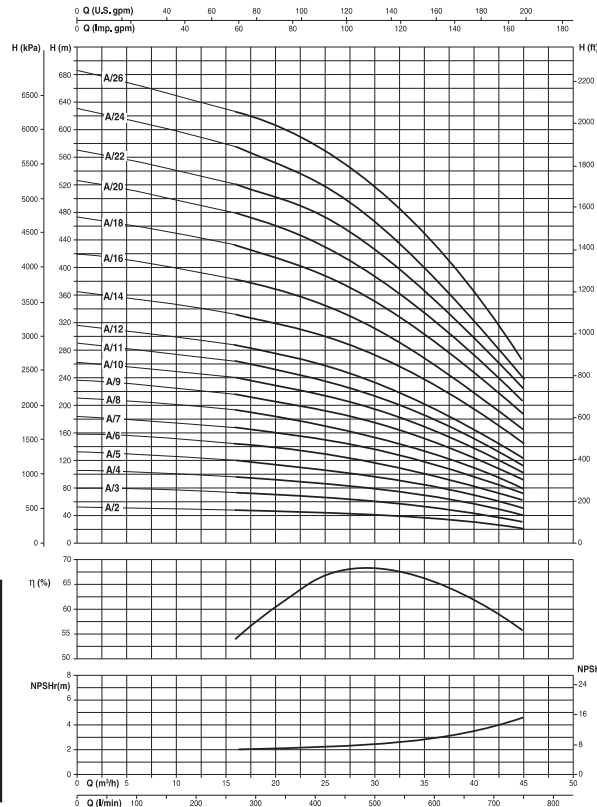

Количество ступеней	<5	5-6	7-8	>8
Коэффициент	0,97	0,98	0,99	1

СКВАЖИННЫЕ НАСОСЫ СЕРИИ NR 201B

2900 1/МИН

Гидравлические характеристики

Тип	Двигатель		Потребляемый ток А 3-400V	U.S.gpm Q л/мин	Q									
	kW	HP			0	158	176	198	220	247	277	308	352	396
NR-201B/2"	9	12.5	19.3	51	46	45	44	42	40	37	33	28	21	
NR-201B/3"	15	20	30.4	77	69	68	66	63	60	56	50	42	31	
NR-201B/4"	18.5	25	38	102	92	90	88	84	80	74	66	56	41	
NR201-B/5"	26	35	52.3	128	115	113	110	105	100	93	83	70	52	
NR-201B/6"	30	40	60.2	153	138	135	132	126	120	111	99	82	59	
NR-201B/7"	37	50	70.5	179	161	158	154	147	140	130	116	98	65	
NR-201B/8"	37	50	70.5	204	184	180	176	168	160	148	132	112	74	
NR-201B/9"	45	60	89	245	216	213	204	199	189	174	153	124	89	
NR-201B/10"	51	70	101	272	240	237	233	224	213	194	174	140	102	
NR-201B/12"	59	80	118	326	288	284	279	269	255	232	211	163	122	
NR-201B/14"	66	90	131	380	336	338	326	314	299	274	241	194	144	
NR-201B/16"	75	100	147	436	390	386	380	369	350	319	282	232	169	
NR-201B/18"	90	125	177	481	439	434	427	415	387	355	312	254	188	
NR-201B/19"	90	125	177	518	463	458	451	435	411	377	338	274	207	
NR-201B/20"	90	125	177	546	488	482	474	461	438	406				

Минимальный гидростатический уровень в м.

	1	1	1	1	1	1	2	2	2
--	---	---	---	---	---	---	---	---	---

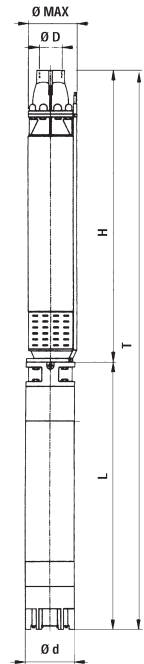

Размеры и вес

Тип		T (mm)	H (mm)	L (mm)	Ø Max (mm)	Ø D "G"	Ø d (mm)	L + H		Kg	
T	H							L	NEMA	H	T
NR-201B/2	RP-201B/2	1297	662	635	190	3"	144	6" MS 152	NEMA 1.18.413	41	95
NR-201B/3	RP-201B/3	1510	735	775	190	3"	144	6" MS 152	NEMA 1.18.413	46	111
NR-201B/4	RP-201B/4	1683	808	875	190	3"	144	6" MS 152	NEMA 1.18.413	51	132
NR201-A/5	RP201-A/5	1936	881	1055	190	3"	144	6" MS 152	NEMA 1.18.413	56	159
NR-201B/6	RP-201B/6	2089	954	1135	190	3"	144	6" MS 152	NEMA 1.18.413	61	170
NR-201B/7	RP-201B/7	2342	1027	1315	190	3"	144	6" MS 152	NEMA 1.18.413	66	196
NR-201B/8	RP-201B/8	2515	1200	1315	190	3"	144	6" MS 152	NEMA 1.18.413	71	201
NR-201B/9	RP-201B/9	2309	1301	1008	198	3"	192	8" MS 200	NEMA 1.18.424	76	235
NR-201B/10	RP-201B/10	2452	1374	1078	198	3"	192	8" MS 200	NEMA 1.18.424	81	253
NR-201B/12	RP-201B/12	2668	1520	1148	198	3"	192	8" MS 200	NEMA 1.18.424	91	279
NR-201B/14	RP-201B/14	2914	1666	1248	198	3"	192	8" MS 200	NEMA 1.18.424	101	304
NR-201B/16	RP-201B/16	3260	1912	1348	198	3"	192	8" MS 200	NEMA 1.18.424	111	332
NR-201B/18	RP-201B/18	3566	2058	1508	198	3"	192	8" MS 200	NEMA 1.18.424	121	372
NR-201B/19	RP-201B/19	3639	2131	1508	198	3"	192	8" MS 200	NEMA 1.18.424	126	377
NR-201B/20	RP-201B/20	3712	2204	1508	198	3"	192	8" MS 200	NEMA 1.18.424	131	382

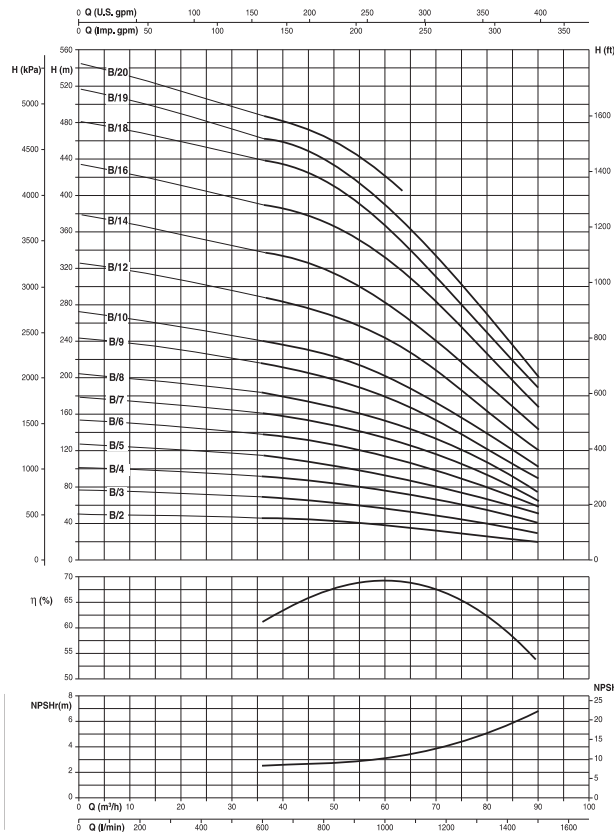

Количество ступеней	<5	5-6	7-8	>8
Коэффициент	0.97	0.98	0.99	1

СКВАЖИННЫЕ НАСОСЫ СЕРИИ NR 201C



2900 1/мин

Гидравлические характеристики

Тип	Двигатель		Порядковый ток А 3~	U.S.g.p.m. Q	H (m)																				
	kW	HP			400V	0	220	247	277	308	352	396	422	476	502	528									
XNR-201C/2A*	11	15	23,8	0	833	933	1050	1167	1333	1500	1600	1800	1900	2000	1	1,5	1,5	2	2,5	3	3,5	4	4	4	
XNR-201C/2*	13	17,5	27,7	50	39	37	35	33	30	24	21	15	10	15	58	48	47	45	42	38	33	30	22	20	15
XNR-201C/3A*	15	20	30,4	75	59	56	53	50	45	36	32	23	22	23	75	59	56	53	50	45	36	32	23	22	23
XNR-201C/3*	18,5	25	38	87	72	71	67	63	57	50	45	33	29	23	87	72	71	67	63	57	50	45	33	29	23
XNR-201C/4*	22	30	43,7	116	96	94	89	84	76	66	60	44	39	30	116	96	94	89	84	76	66	60	44	39	30
XNR-201C/5*	30	40	60,2	145	120	118	111	105	95	83	75	55	49	38	145	120	118	111	105	95	83	75	55	49	38
XNR-201C/6*	37	50	70,5	174	144	141	133	126	114	99	90	66	58	45	174	144	141	133	126	114	99	90	66	58	45
XNR-201C/7*	45	60	89	203	168	165	156	147	133	116	105	82	68	53	203	168	165	156	147	133	116	105	82	68	53
XNR-201C/8*	45	60	89	232	192	188	178	168	152	132	120	93	78	60	232	192	188	178	168	152	132	120	93	78	60
XNR-201C/9*	51	70	101	261	216	212	200	189	171	149	135	105	88	68	261	216	212	200	189	171	149	135	105	88	68
XNR-201C/10*	59	80	118	290	240	235	222	210	190	165	150	115	97	75	290	240	235	222	210	190	165	150	115	97	75
XNR-201C/11*	66	90	131	319	264	259	245	231	209	182	165	121	107	83	319	264	259	245	231	209	182	165	121	107	83
XNR-201C/12*	75	100	147	348	288	282	266	252	228	198	180	132	116	90	348	288	282	266	252	228	198	180	132	116	90
XNR-201C/13*	75	100	147	377	312	306	289	273	247	215	195	151	127	98	377	312	306	289	273	247	215	195	151	127	98
XNR-201C/14*	90	125	177	406	336	329	311	294	266	231	210	159	136	105	406	336	329	311	294	266	231	210	159	136	105
XNR-201C/15*	90	125	177	435	360	353	333	315	285	248	225	173	146	113	435	360	353	333	315	285	248	225	173	146	113

Размеры и вес

Тип		T (mm)	H (mm)	L (mm)	Ø Max (mm)	Ø D "G"	Ø d (mm)	L + H		Kg	
T	H							L	NEMA	H	T
NR-201C/2A	RP-201C/2A	1347	662	685	190	3"	144	6" MS 152	NEMA 1.18.413	41	101
NR-201C/2	RP-201C/2	1387	662	725	190	3"	144	6" MS 152	NEMA 1.18.413	41	103
NR-201C/3A	RP-201C/3A	1510	735	775	190	3"	144	6" MS 152	NEMA 1.18.413	46	109
NR-201C/3	RP-201C/3	1610	735	875	190	3"	144	6" MS 152	NEMA 1.18.413	46	127
NR-201C/4	RP-201C/4	1773	808	965	190	3"	144	6" MS 152	NEMA 1.18.413	51	142
NR-201C/5	RP-201C/5	2016	881	1135	190	3"	144	6" MS 152	NEMA 1.18.413	56	165
NR-201C/6	RP-201C/6	2269	954	1315	190	3"	144	6" MS 152	NEMA 1.18.413	61	191
NR-201C/7	RP-201C/7	2062	1054	1008	198	3"	192	8" MS 200	NEMA 1.18.424	66	225
NR-201C/8	RP-201C/8	2235	1227	1008	198	3"	192	8" MS 200	NEMA 1.18.424	71	230
NR-201C/9	RP-201C/9	2378	1300	1078	198	3"	192	8" MS 200	NEMA 1.18.424	76	248
NR-201C/10	RP-201C/10	2521	1373	1148	198	3"	192	8" MS 200	NEMA 1.18.424	81	269
NR-201C/11	RP-201C/11	2694	1446	1248	198	3"	192	8" MS 200	NEMA 1.18.424	86	289
NR-201C/12	RP-201C/12	2867	1519	1348	198	3"	192	8" MS 200	NEMA 1.18.424	91	312
NR-201C/13	RP-201C/13	2940	1592	1348	198	3"	192	8" MS 200	NEMA 1.18.424	96	317
NR-201C/14	RP-201C/14	3173	1665	1508	198	3"	192	8" MS 200	NEMA 1.18.424	101	352
NR-201C/15	RP-201C/15	3246	1738	1508	198	3"	192	8" MS 200	NEMA 1.18.424	106	357

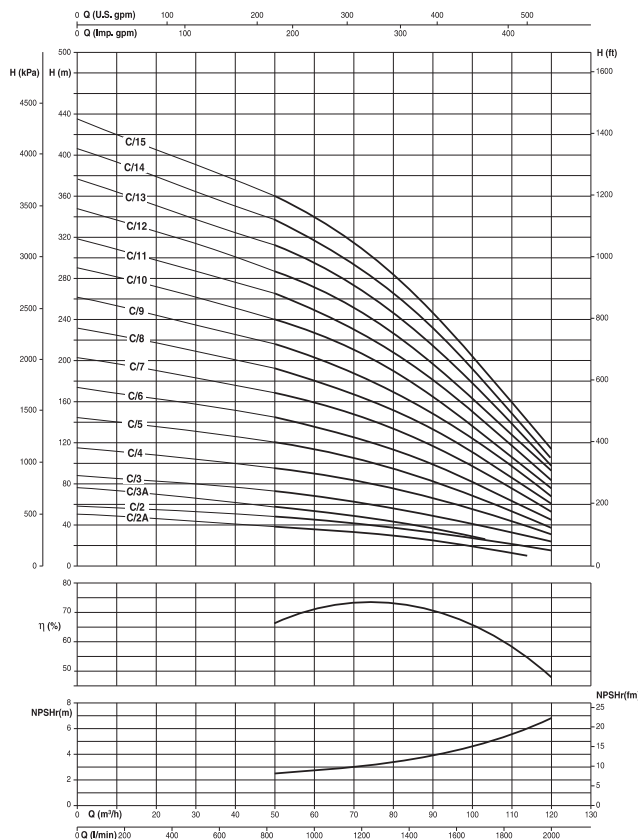
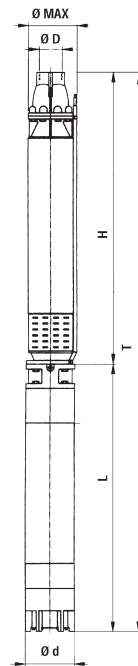

Количество ступеней	<5	5-6	7-8	>8
Коэффициент	0,97	0,98	0,99	1

СКВАЖИННЫЕ НАСОСЫ СЕРИИ S 181 A-B-C -D



2900 1/мин

Гидравлические характеристики

Тип	Двигатель		Потребляемый ток - А Э~ 400V	Q																
	kW	HP		U.S.g.p.m.	0	422	476	502	528	555	581	634	705	740	793	845	898	951	1004	
				M³/h	0	96	108	114	120	126	132	144	160	168	180	192	204	216	228	
				l/min	0	1600	1800	1900	2000	2100	2200	2400	2667	2800	3000	3200	3400	3600	3800	
S-181C/1 *	7,5	10	16,3	H (m)	27	18	17	16	16	15	15	14	11							
S-181C/2B *	11	15	23,8		44	32	28	26	25	23	21	17								
S-181C/2 *	15	20	30,4		55	39	37	36	33	32	30	27	22							
S-181C/3A *	18,5	25	38		76	52	48	46	44	42	39	33	25							
S-181C/3 *	22	30	43,7		82	58	54	52	50	48	45	39	33							
S-181C/4A *	26	35	52,3		97	69	62	60	58	54	53	45	34							
S-181C/4 *	30	40	60,2		109	79	73	71	67	64	60	52	44							
S-181C/5 *	37	50	70,5		139	99	95	91	87	84	80	71	60							
S-181C/6 *	45	60	89		164	118	112	109	106	103	98	87	72							
S-181C/7 *	51	70	101		189	137	131	127	122	118	112	99	84							
S-181C/8 *	59	80	118		216	157	151	145	141	134	128	110	88							
S-181C/9 *	66	90	131		243	177	170	165	159	151	144	124	99							
S-181C/10	75	100	147	270	196	188	183	177	168	160	138	110								
S-181C/11	90	125	177	297	216	208	201	194	184	176	151	121								
S-181C/12	90	125	177	324	236	227	219	212	203	192	166	132								
Минимальный гидростатический уровень в м.					2	2	2	3	4	5	5	5								
S-181D/1 *	9	12,5	19,3	H (m)	28		22	21	20,5	20	19	18	17	16	14	12	10	7	5	
S-181D/2A *	15	20	30,4		47		33	32	31	30	29	27	24	22	19	16	13			
S-181D/2 *	18,5	25	38		56		43	42	41	40	39	37	33	31	28	24	20	17	12	
S-181D/3A *	22	30	43,7		71		51	49	48	46	45	42	37	34	30					
S-181D/3 *	30	40	60,2		86		65	63	62	60	59	55	50	47	43	38	32	26	18	
S-181D/4 *	37	50	70,5		115		87	85	83	81	79	74	67	63	57	49	42	34	26	
S-181D/5 *	51	70	101		140		106	103	101	98	95	92	81	78	70	61	52	41	30	
S-181D/6 *	59	80	118		168		128	125	122	119	116	109	99	93	84	75	63	51	36	
S-181D/7 *	66	90	131		196		152	147	144	140	136	128	115	109	99	85	73	60	42	
S-181D/8	75	100	147	224		171	168	165	161	158	149	136	129	114	100	85	68	53		
S-181D/9	90	125	177	252		194	189	185	182	178	169	156	146	131	116	100	82	64		
Минимальный гидростатический уровень в м.						2	2	2	3	3	4	4	5	5	5	5	5	5	5	

Рабочие графики построены при испытании с жидкостью плотностью 1000 кг/м³ и кинематической вязкостью 1 мм²/сек.

2900 1/мин

Гидравлические характеристики

Тип	Двигатель		Потребляемый ток - А 3~ 400V	U.S.g.p.m.										
	kW	HP		Q м³/ч	0	106	132	158	185	211	264	317	370	440
				H (m)	0	400	500	600	700	800	1000	1200	1400	1667
S-181A/1*	5,5	7,5	12,3	27	24	23	22	22	21,5	19	17	14	10	
S-181A/2A*	7,5	10	16,3	47	41	38	37,5	36	34	29	27	19	15	
S-181A/2*	9	12,5	19,3	54	48	47	46	43	41	37	32	24	19	
S-181A/3A*	11	15	23,8	71	62	57	54	51	48	44	38	30	21	
S-181A/3*	13	17,5	27,7	81	72	69	66	63	60	52	45	36	29	
S-181A/4A*	15	20	30,4	94	82	77	73	69	65	58	51	39	30	
S-181A/4*	18,5	25	38	108	96	93	89	86	82	74	66	53	39	
S-181A/5*	22	30	43,7	135	120	115	111	108	103	93	83	70	49	
S-181A/6*	26	35	52,3	162	144	139	133	129	124	116	104	85	58	
S-181A/7*	30	40	60,2	189	173	167	162	160	153	144	129	106	68	
S-181A/8*	37	50	70,5	216	192	189	182	177	172	161	141	121	78	
S-181A/9*	45	60	89	243	217	210	205	198	192	175	156	134	88	
S-181A/10*	45	60	89	270	240	232	224	217	210	193	170	148	97	
S-181A/11	51	70	101	297	264	256	248	238	231	212	184	163	107	
S-181A/12	59	80	118	324	289	278	270	260	252	232	204	177	117	
S-181A/13	59	80	118	351	312	302	292	282	273	251	225	192	127	
Минимальный гидростатический уровень в м.					1	1	1	1	1	1	1	1	1	

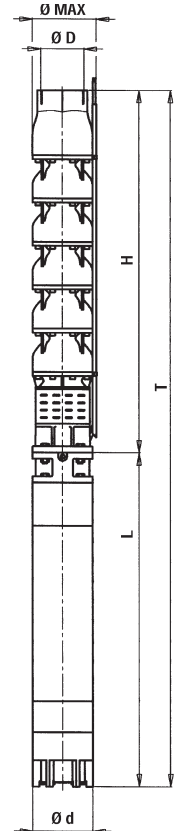

Размеры и вес

Тип		T (mm)	H (mm)	L (mm)	Ø Max (mm)	Ø D °G	Ø d (mm)	L + H			Kg	
T	H							L	NEMA	H	T	
S-181A/1	SP-181A/1	1162	610	552	202	5"	144	6" MS 152	NEMA 1.18.413	36,5	80,5	
S-181A/2A	SP-181A/2A	1205	750	595	202	5"	144	6" MS 152	NEMA 1.18.413	49	98	
S-181A/2	SP-181A/2	1385	750	635	202	5"	144	6" MS 152	NEMA 1.18.413	49	103	
S-181A/3A	SP-181A/3A	1575	890	685	202	5"	144	6" MS 152	NEMA 1.18.413	61,5	121,5	
S-181A/3	SP-181A/3	1615	890	725	202	5"	144	6" MS 152	NEMA 1.18.413	61,5	123,5	
S-181A/4A	SP-181A/4A	1805	1030	775	202	5"	144	6" MS 152	NEMA 1.18.413	74	139	
S-181A/4	SP-181A/4	1905	1030	875	202	5"	144	6" MS 152	NEMA 1.18.413	74	155	
S-181A/5	SP-181A/5	2135	1170	965	202	5"	144	6" MS 152	NEMA 1.18.413	86,5	177,5	
S-181A/6	SP-181A/6	2365	1310	1055	202	5"	144	6" MS 152	NEMA 1.18.413	99	202	
S-181A/7	SP-181A/7	2585	1450	1135	202	5"	144	6" MS 152	NEMA 1.18.413	111,5	220,5	
S-181A/8	SP-181A/8	2905	1590	1315	202	5"	144	6" MS 152	NEMA 1.18.413	124	254	
S-181A/9	SP-181A/9	2738	1730	1008	202	5"	192	8" MS 200	NEMA 1.18.424	136,5	295,5	
S-181A/10	SP-181A/10	2878	1870	1008	202	5"	192	8" MS 200	NEMA 1.18.424	149	308	
S-181A/11	SP-181A/11	3088	2010	1078	202	5"	192	8" MS 200	NEMA 1.18.424	161,5	333,5	
S-181A/12	SP-181A/12	3298	2150	1148	202	5"	192	8" MS 200	NEMA 1.18.424	174	362	
S-181A/13	SP-181A/13	3438	2290	1148	202	5"	192	8" MS 200	NEMA 1.18.424	186,5	374,5	

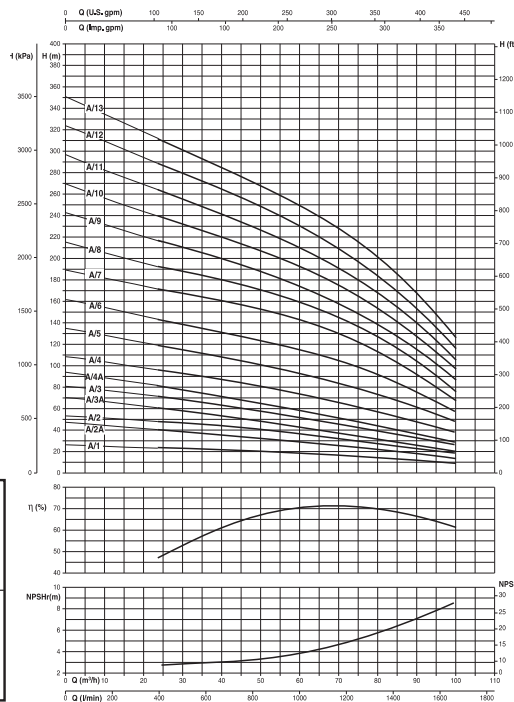
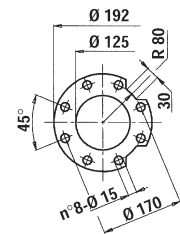

Количество ступеней	<5	5-6	7-8	>8
Коэффициент	0,97	0,98	0,99	1

СКВАЖИННЫЕ НАСОСЫ СЕРИИ S 181 В



Гидравлические характеристики

2900 1/мин

Тип	Двигатель		Потребляемый ток - А 3~ 400V	U.S.g.p.m.		0		211	264	317	370	440	476	502	528	555	594	638		
	kW	HP		Q	0	211	264	317	370	440	476	502	528	555	594	638				
				л/мин	0	800	1000	1200	1400	1667	1800	1900	2000	2100	2250	2417				
S-181B/1*	7,5	10	14,3	H (m)	28	25	24,5	24	23	20,5	20	18	17	15	13	8				
S-181B/2B*	9	12,5	19,3		45	37	35	33	29	25,5	25	21	21	22	17	7				
S-181B/2A*	11	15	23,8		50	42	40	38	36	32	30	27	25	22	17	7				
S-181B/2*	13	17,5	27,7		57	49	47	45	43	39,5	39	36	34	30	25	18				
S-181B/3B*	15	20	30,4		67	56	52	51	48											
S-181B/3A*	18,5	25	38		71	61	58	54	51	44,5	42	38	36	33	26	18				
S-181B/3*	22	30	43,7		85	74	72	69	65	59	56	53	50	46	38	28				
S-181B/4*	26	35	52,8		114	98	94	90	84	76,5	70	66	62	56	48	36				
S-181B/5A*	30	40	60,2		123	105	101	96	88											
S-181B/5*	37	50	70,5		142	123	118	113	109	98,5	93	87	81	73	60					
S-181B/6*	45	60	89		162	146	140	133	127	115	107	101	95	87	72	55				
S-181B/7*	51	70	101		189	170	163	155	148	135	127	120	112	102	87	67				
S-181B/8*	59	80	118		216	194	186	177	169	153	145	137	127	118	102	80				
S-181B/9*	59	80	118	243	223	213	205	194	180	169	159	150	139	123	101					
S-181B/10*	66	90	131	277	246	237	227	218	199	188	178	166	154	138	113					
S-181B/11	75	100	147	305	271	260	249	240	220	207	196	183	170	148	118					
S-181B/12	90	125	177	332	295	284	272	259	237	223	211	199	184	163	123					
S-181B/13	90	125	177	360	320	307	294	283	258	244	232	218	205	180	133					

Минимальный гидростатический уровень в м.

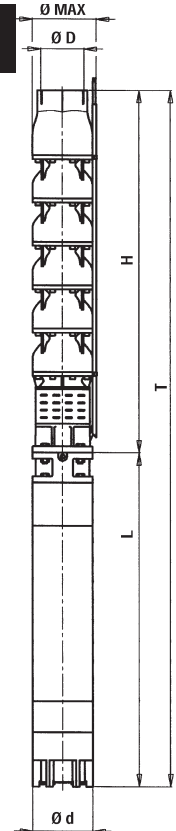

Размеры и вес

Тип		T	H	L	Ø Max	Ø D	Ø d	L + H	Kg		
T	H	(mm)	(mm)	(mm)	(mm)	(mm)	(mm)	L	NEMA	H	T
S-181B/1	SP-181B/1	1205	610	595	202	5"	1.44	6" MS 152	NEMA 1.18.413	37	86
S-181B/2B	SP-181B/2B	1385	750	635	202	5"	1.44	6" MS 152	NEMA 1.18.413	48,5	102,5
S-181B/2A	SP-181B/2A	1435	750	685	202	5"	1.44	6" MS 152	NEMA 1.18.413	48,5	108,5
S-181B/2	SP-181B/2	1475	750	725	202	5"	1.44	6" MS 152	NEMA 1.18.413	48,5	110,5
S-181B/3B	SP-181B/3B	1665	890	775	202	5"	1.44	6" MS 152	NEMA 1.18.413	60	125
S-181B/3A	SP-181B/3A	1765	890	875	202	5"	1.44	6" MS 152	NEMA 1.18.413	60	141
S-181B/3	SP-181B/3	1855	890	965	202	5"	1.44	6" MS 152	NEMA 1.18.413	60	151
S-181B/4	SP-181B/4	2085	1030	1055	202	5"	1.44	6" MS 152	NEMA 1.18.413	71,5	174,5
S-181B/5A	SP-181B/5A	2305	1170	1135	202	5"	1.44	6" MS 152	NEMA 1.18.413	83	192
S-181B/5	SP-181B/5	2485	1170	1315	202	5"	1.44	6" MS 152	NEMA 1.18.413	83	213
S-181B/6	SP-181B/6	2318	1310	1008	202	5"	1.92	8" MS 200	NEMA 1.18.424	94,5	253,5
S-181B/7	SP-181B/7	2528	1450	1078	202	5"	1.92	8" MS 200	NEMA 1.18.424	106	278
S-181B/8	SP-181B/8	2738	1590	1148	202	5"	1.92	8" MS 200	NEMA 1.18.424	117,5	305,5
S-181B/9	SP-181B/9	2878	1730	1148	202	5"	1.92	8" MS 200	NEMA 1.18.424	129	317
S-181B/10	SP-181B/10	3118	1870	1248	202	5"	1.92	8" MS 200	NEMA 1.18.424	140,5	343,5
S-181B/11	SP-181B/11	3358	2010	1348	202	5"	1.92	8" MS 200	NEMA 1.18.424	152	373
S-181B/12	SP-181B/12	3658	2150	1508	202	5"	1.92	8" MS 200	NEMA 1.18.424	163,5	414,5
S-181B/13	SP-181B/13	3798	2290	1508	202	5"	1.92	8" MS 200	NEMA 1.18.424	175	426

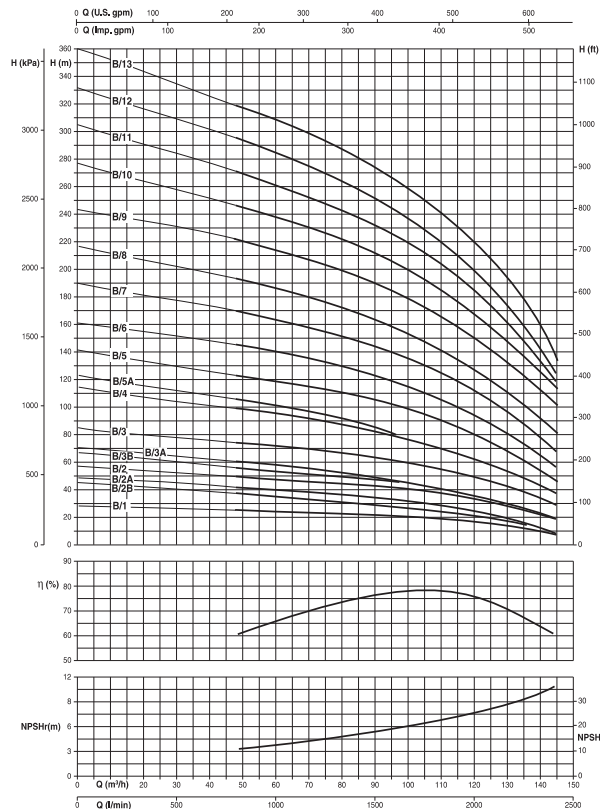
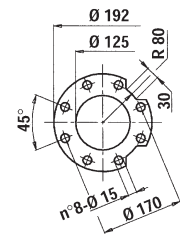

Количество ступеней	<5	5-6	7-8	>8
Коэффициент	0,97	0,98	0,99	1

СКВАЖИННЫЕ НАСОСЫ СЕРИИ S 181 C

2900 1/мин

Гидравлические характеристики

Тип	Двигатель		Потребляемый ток А 3~	U.S.g.p.m. Q M ³ /ч l/min	H (m)								
	kW	HP			400V	0	422	476	502	528	555	581	634
S-181C/1*	7,5	10	16,3	27	18	17	16	16	15	15	14	11	
S-181C/2B*	11	15	23,8	44	32	28	26	25	23	21	17		
S-181C/2*	15	20	30,4	55	39	37	36	33	32	30	27	22	
S-181C/3A*	18,5	25	38	76	52	48	46	44	42	39	33	25	
S-181C/3*	22	30	43,7	82	58	54	52	50	48	45	39	33	
S-181C/4A*	26	35	52,3	97	69	62	60	58	54	53	45	34	
S-181C/4*	30	40	60,2	109	79	73	71	67	64	60	52	44	
S-181C/5*	37	50	70,5	139	99	95	91	87	84	80	71	60	
S-181C/6*	45	60	89	164	118	112	109	106	103	98	87	72	
S-181C/7*	51	70	101	189	137	131	127	122	118	112	99	84	
S-181C/8*	59	80	118	216	157	151	145	141	134	128	110	88	
S-181C/9*	66	90	130	243	177	170	165	159	151	144	124	99	
S-181C/10	75	100	147	270	196	188	183	177	168	160	138	110	
S-181C/11	90	125	177	297	216	208	201	194	184	176	151	121	
S-181C/12	90	125	177	324	236	227	219	212	203	192	166	132	

Минимальный гидростатический уровень в м.

	2	2	2	3	4	5	5	5
--	---	---	---	---	---	---	---	---

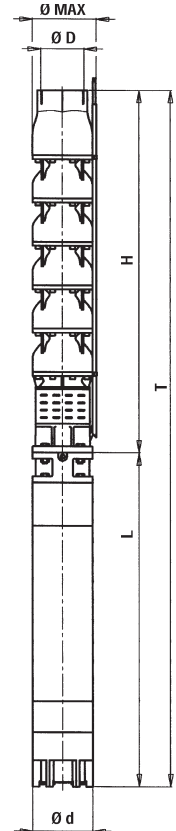

Размеры и вес

Тип		T	H	L	Ø Max	Ø D	Ø d	L + H		Kg	
T	H	(mm)	(mm)	(mm)	(mm)	°C	(mm)	L	NEMA	H	T
S-181C/1	SP-181C/1	1205	610	595	202	5°	144	6" MS 152	NEMA 1.18.413	38,5	87,5
S-181C/2B	SP-181C/2B	1435	750	685	202	5°	144	6" MS 152	NEMA 1.18.413	50	110
S-181C/2	SP-181C/2	1525	750	775	202	5°	144	6" MS 152	NEMA 1.18.413	50	115
S-181C/3A	SP-181C/3A	1765	890	875	202	5°	144	6" MS 152	NEMA 1.18.413	61,5	142,5
S-181C/3	SP-181C/3	1855	890	965	202	5°	144	6" MS 152	NEMA 1.18.413	61,5	152,5
S-181C/4A	SP-181C/4A	2085	1030	1055	202	5°	144	6" MS 152	NEMA 1.18.413	73	176
S-181C/4	SP-181C/4	2165	1030	1135	202	5°	144	6" MS 152	NEMA 1.18.413	73	182
S-181C/5	SP-181C/5	2485	1170	1315	202	5°	144	6" MS 152	NEMA 1.18.413	84,5	214,5
S-181C/6	SP-181C/6	2318	1310	1008	202	5°	192	8" MS 200	NEMA 1.18.424	96	255
S-181C/7	SP-181C/7	2528	1450	1078	202	5°	192	8" MS 200	NEMA 1.18.424	107,5	279,5
S-181C/8	SP-181C/8	2738	1590	1148	202	5°	192	8" MS 200	NEMA 1.18.424	119	307
S-181C/9	SP-181C/9	2978	1730	1248	202	5°	192	8" MS 200	NEMA 1.18.424	130,5	333,5
S-181C/10	SP-181C/10	3218	1870	1348	202	5°	192	8" MS 200	NEMA 1.18.424	142	363
S-181C/11	SP-181C/11	3358	2010	1348	202	5°	192	8" MS 200	NEMA 1.18.424	153,5	374,5
S-181C/12	SP-181C/12	3658	2150	1508	202	5°	192	8" MS 200	NEMA 1.18.424	165	416
S-181C/13	SP-181C/13	3798	2290	1508	202	5°	192	8" MS 200	NEMA 1.18.424	176,5	427,5

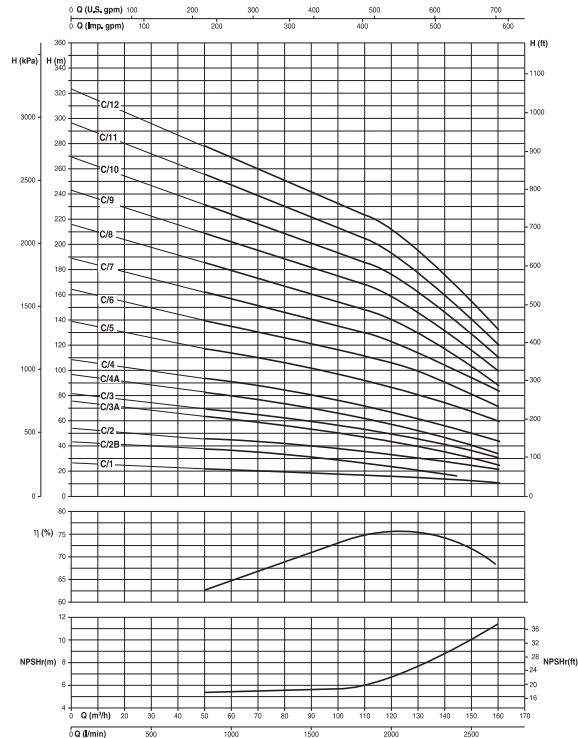
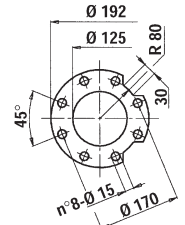

Количество ступеней	<5	5-6	7-8	>8
Коэффициент	0,97	0,98	0,99	1

СКВАЖИННЫЕ НАСОСЫ СЕРИИ S 181 D



2900 1/мин

Гидравлические характеристики

Тип	Двигатель		Потребляемый ток А 3~ 400V	U.S.g.p.m.	0	476	502	528	555	581	634	705	740	793	845	898	951	1004	
	kW	HP		Q м³/ч	0	108	114	120	126	132	144	160	168	180	192	204	216	228	
				H (m)	0	1800	1900	2000	2100	2200	2400	2667	2800	3000	3200	3400	3600	3800	
S-181D/1*	9	12,5	19,3	H (m)	28	22	21	20,5	20	19	18	17	16	14	12	10	7	5	
S-181D/2A*	15	20	30,4		47	33	32	31	30	29	27	24	22	19	16	13			
S-181D/2*	18,5	25	38		56	43	42	41	40	39	37	33	31	28	24	20	17	12	
S-181D/3A*	22	30	43,7		71	51	49	48	46	45	42	37	34	30					
S-181D/3*	30	40	60,2		86	65	63	62	60	59	55	50	47	43	38	32	26	18	
S-181D/4*	37	50	70,5		115	87	85	83	81	79	74	67	63	57	49	42	34	26	
S-181D/5*	51	70	101		140	106	103	101	98	95	92	81	78	70	61	52	41	30	
S-181D/6*	59	80	118		168	128	125	122	119	116	109	99	93	84	75	63	51	36	
S-181D/7*	66	90	131		196	152	147	144	140	136	128	115	109	99	85	73	60	42	
S-181D/8*	75	100	147		224	171	168	165	161	158	149	136	129	114	100	85	68	53	
S-181D/9*	90	125	177	252	194	189	185	182	178	169	156	146	131	116	100	82	64		
Минимальный гидростатический уровень в м.						2	2	2	3	3	4	4	5	5	5	5	5	5	

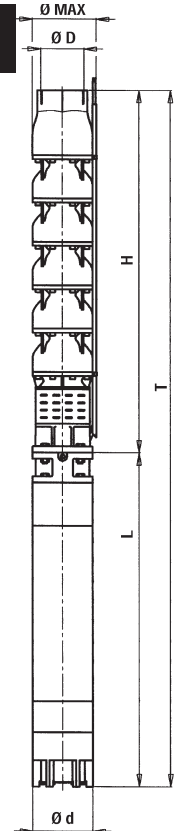

Размеры и вес

Тип		T (mm)	H (mm)	L (mm)	Ø Max (mm)	Ø D "G"	Ø d (mm)	L + H		Kg	
T	H							L	NEMA	H	T
S-181D/1	SP-181D/1	1245	610	635	202	5"	144	6" MS 152	NEMA 1.18.413	39	93
S-181D/2A	SP-181D/2A	1525	750	775	202	5"	144	6" MS 152	NEMA 1.18.413	50,5	115,5
S-181D/2	SP-181D/2	1625	750	875	202	5"	144	6" MS 152	NEMA 1.18.413	50,5	131,5
S-181D/3A	SP-181D/3A	1855	890	965	202	5"	144	6" MS 152	NEMA 1.18.413	62	153
S-181D/3	SP-181D/3	2025	890	1135	202	5"	144	6" MS 152	NEMA 1.18.413	62	171
S-181D/4	SP-181D/4	2345	1030	1315	202	5"	144	6" MS 152	NEMA 1.18.413	73,5	203,5
S-181D/5	SP-181D/5	2248	1170	1078	202	5"	192	8" MS 200	NEMA 1.18.424	85	257
S-181D/6	SP-181D/6	2458	1310	1148	202	5"	192	8" MS 200	NEMA 1.18.424	96,5	284,5
S-181D/7	SP-181D/7	2698	1450	1248	202	5"	192	8" MS 200	NEMA 1.18.424	108	311
S-181D/8	SP-181D/8	2938	1590	1348	202	5"	192	8" MS 200	NEMA 1.18.424	119,5	340,5
S-181D/9	SP-181D/9	3238	1730	1508	202	5"	192	8" MS 200	NEMA 1.18.424	131	382

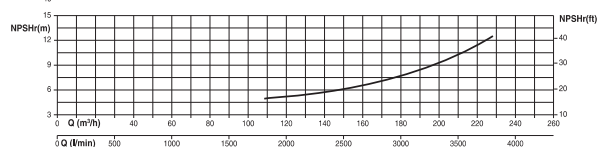
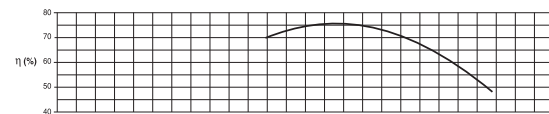
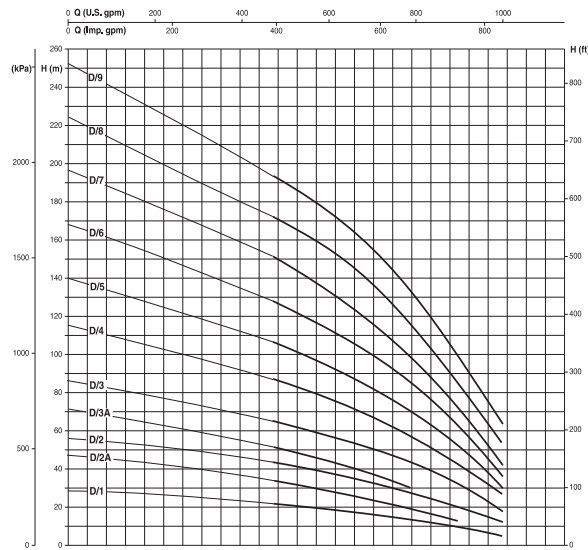
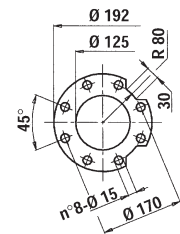

Количество ступеней	<5	5-6	7-8	>8
Коэффициент	0,97	0,98	0,99	1